

FLUSH WALL CLOSURE

ECLISSE SYNTESIS® TECH - DIMENSIONS



ECLISSE SYNTESIS® TECH is the solution that completes ECLISSE SYNTESIS® COLLECTION's range. It allows to contain technical rooms. Electrical wiring, plumbing, and even closets can now be concealed and discreetly integrated into the wall.

Thanks to ECLISSE SYNTESIS® TECH, the wall looks completely unchanged while the technical spaces remain accessible, to be open only when needed through comfortable push-pull openings.

On demand are also available handles with lever or with key.

Customizable with any type of opening, single or double leaf, folding or removable panel, it allows you to hide any item or equipment that we do not want to be visible, leaving it inspectable for any maintenance.

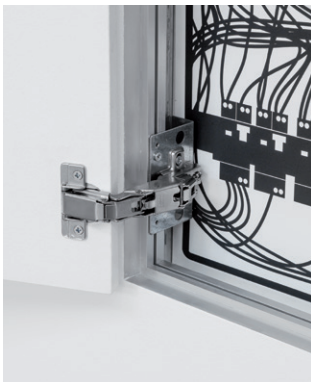

DIMENSIONS

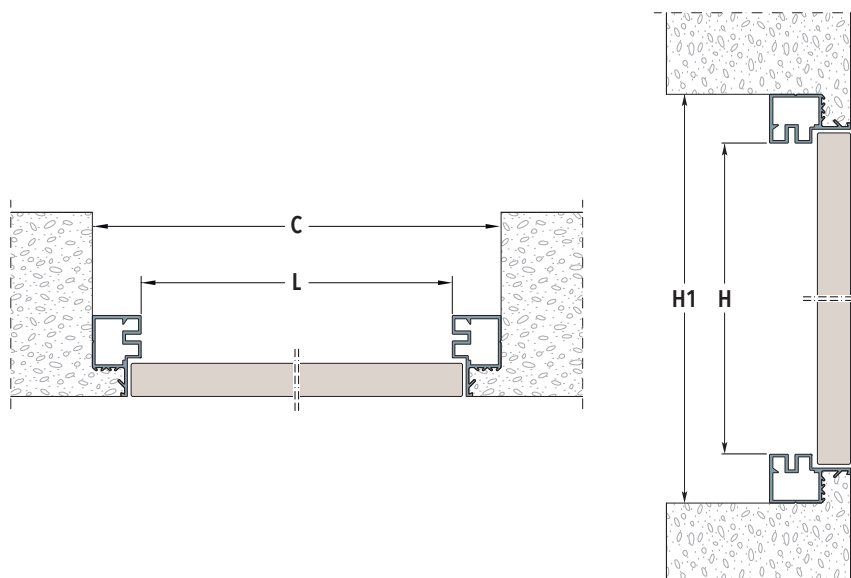

i OVERALL DIMENSIONS

$$C = L + 53 \text{ mm}$$

$$H1 = H + 53 \text{ mm}$$

FLUSH WALL CLOSURE

ECLISSE SYNTESIS® TECH - APPLICATIONS - OPENINGS

APPLICATIONS

Frame on solid wall

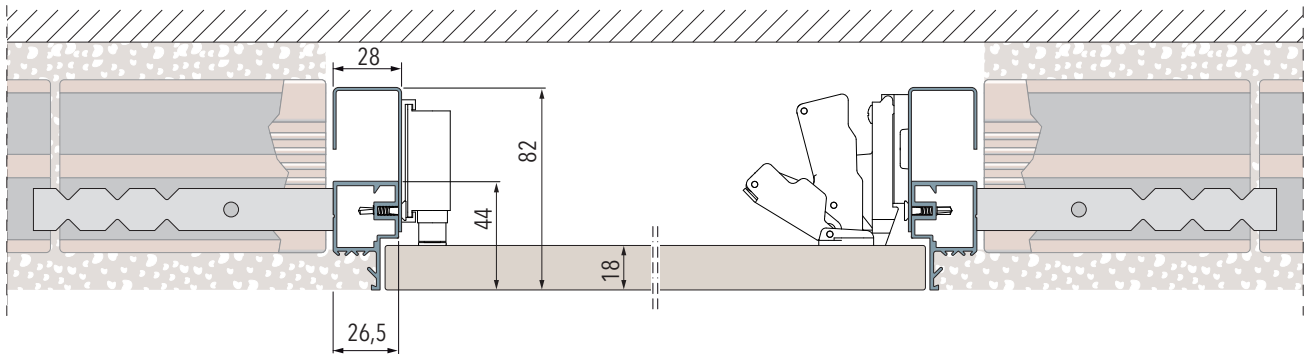

Frame on stud wall with one plasterboard layer

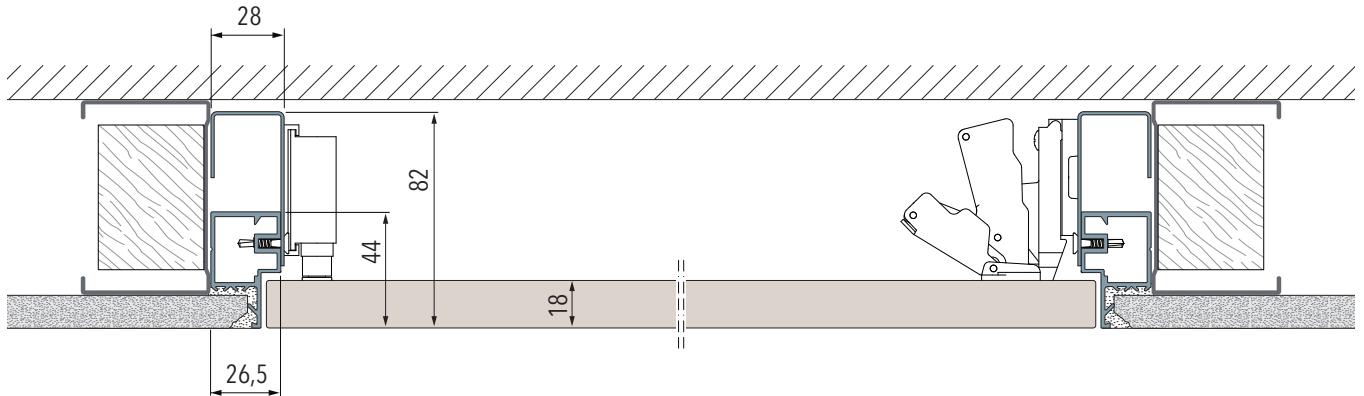

Frame on stud wall with two plasterboard layers

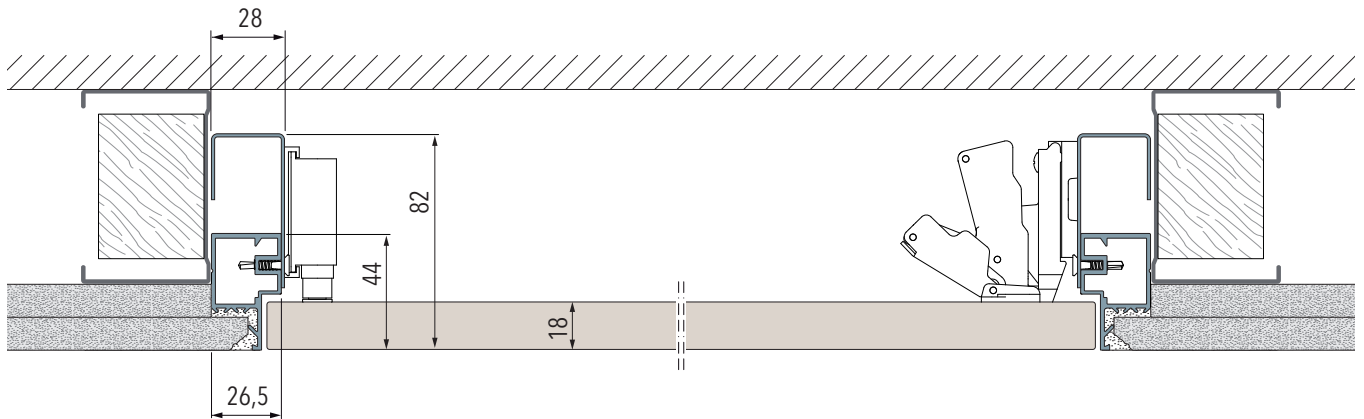

FLUSH WALL CLOSURE

ECLISSE SYNTESIS® TECH - VERSIONS

SINGLE DOOR

Option with hinges on the vertical side

(Useful space between hinge and lock around 100 mm less than the passage size)

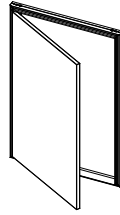

A single frame for right-hinged or left-hinged opening

PASSAGE SIZE					OVERALL DIMENSIONS						
min	L	max	min	H	max	min	C	max	min	H1	max
300	÷	600	300	÷	1600	353	÷	653	353	÷	1653

DOUBLE DOOR

Option with hinges on the vertical side

(Useful space between hinge and lock around 150 mm less than the passage size)

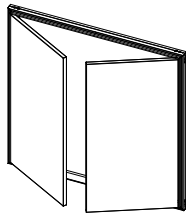

Not available with key-lock

PASSAGE SIZE					OVERALL DIMENSIONS						
min	L	max	min	H	max	min	C	max	min	H1	max
600	÷	1000	300	÷	1600	653	÷	1053	353	÷	1653
300+300	÷	500+500									

TOP-HUNG PANEL

BOTTOM-HINGED PANEL

REMOVABLE PANEL

Option with hinges on the horizontal side

(Useful space between hinge and lock around 100 mm less than the passage size)

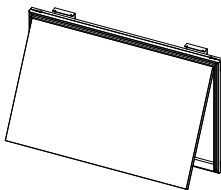

Hold open device supplied as standard

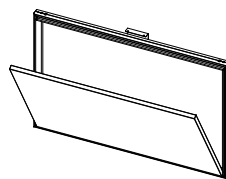

Safety chain device supplied as standard

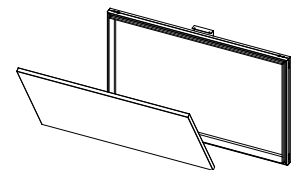

Safety chain device supplied as standard

PASSAGE SIZE					OVERALL DIMENSIONS						
min	L	max	min	H	max	min	C	max	min	H1	max
300	÷	1600	300	÷	600	353	÷	1653	353	÷	653

NOTES

Single door:

- Supplied with push-pull opening system as standard.

Double door:

- Supplied with push-pull opening system as standard.

Dimensions are given in mm.