

ECLISSE DELTA

TECHNICAL DETAILS



ECLISSE DELTA is the new aluminium baseboard which redefines the concept. Its appearance along the length of the wall is understated yet unmistakeable.

Like a good theatrical production, this baseboard presents a frontal illusion of a flush effect which emphasises the nature of the wall. But the true magic is revealed when the viewing angle is changed: The viewer is pleasantly surprised by the unexpected slant in ECLISSE DELTA, which divides up the space and imbues the environment with a unique expressive force.

The pattern of the three-dimensional terminal pieces is also very novel and lends them an unmistakeable, unique appearance.

Aesthetics

With its special viewing angle feature, ECLISSE DELTA divides the space up with well-defined, geometric lines. The baseboard is the perfect foil for a modern, avant-garde style, compatible with ECLISSE Syntesis® Collection, ECLISSE 40 Collection.

Technical features and finishes

ECLISSE DELTA is available in two different heights (50 and 70 mm) to satisfy different furnishing requirements. It is tapered from 13.5 mm to 1.6 mm, which is the same for both heights. ECLISSE DELTA is manufactured from aluminium in three variants: anodised aluminium, painted white and painted black. The special terminal pieces also highlight a precise finish close to the passage width of the doorway.

Application

Upon completion of the installation, ECLISSE DELTA can be fitted easily and without any special procedures simply using only silicone.

APPLICATIONS



2000 mm aluminium profiles for fastening to the wall.
Height 50 mm.

2000 mm aluminium profiles for fastening to the wall.
Height 70 mm.

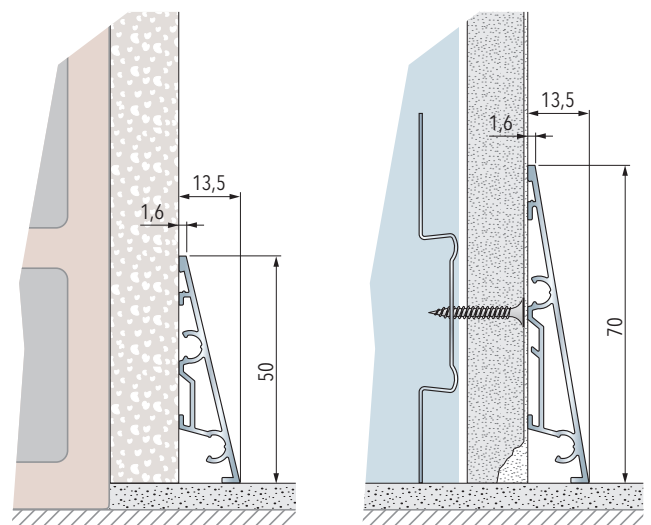

Baseboard installed on solid wall

Baseboard installed on stud wall (one layer of plasterboard)

ECLISSE DELTA

JOINTS and FINISHES

JOINTS FOR CONNECTING THE PROFILES

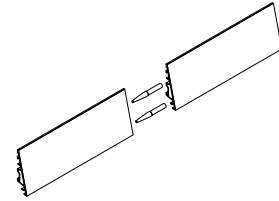
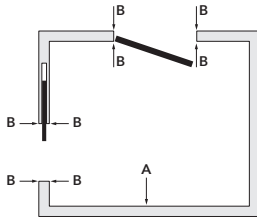

PACK OF 40 JOINT
(see item **A** in the figure)

TERMINAL PROFILES (2 right - 2 left)

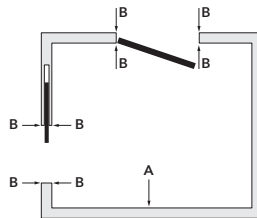

TAPERED TERMINAL PROFILE

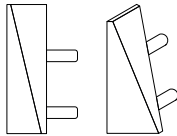

PACK OF 4 TERMINAL PROFILES
(see item **B** in the figure)

STRAIGHT TERMINAL PROFILE

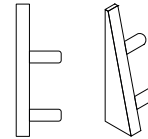

PACK OF 4 TERMINAL PROFILES
(see item **B** in the figure)

FINISHES

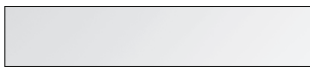

PRIMER-COATED



ANODISED ALUMINIUM

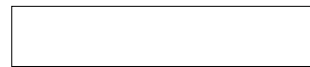

WHITE



BLACK

NOTES

- * **Joints:** 2 connectors are needed for each profile to be connected
- ▶ Adhesive sealant for solid wall; one pack of adhesive for 25 linear metres